



I P FRAUD INVESTIGATIONS

**23 NOVEMBER 2017**

**IPFI/8DS/CASE1**

**ADMISSION**

**From:** John Ridge [mailto:r [REDACTED] m]  
**Sent:** 23 November 2017 18:28  
**To:** Andrew Hall  
**Subject:** The Stables

Dear Andrew

Following our discussion earlier, I'm attaching a photograph of part of a plan sent to me on 7 January 2000 by John Houldsworth, with ref: JHH/JAB/8544-1-8. It includes the location outlined in red of The Stables, Duck Street, as part of an application for a drinks licence by Aftab Miah, the then tenant.

The scale is unhelpfully small, but I can clearly see that some structure, with an internal wall, abuts the boundary wall of the Stables yard on the North East side of the yard. This I now assume to be the privies that you have told me about. If so, I can assure you that they have never been part of the yard during our ownership of the Stables, and we never had or claimed any rights over the building - indeed, I have never seen the building, and was unaware of its existence until a few days ago.

The red outline shows the boundary of the yard as it was at the time of the transfer of the property to my wife, and it remained so up to our sale of the property to Michael Robinson.

Please let me know if there is anything on which you would like further clarification.

With best wishes  
John Ridge

r [REDACTED] om

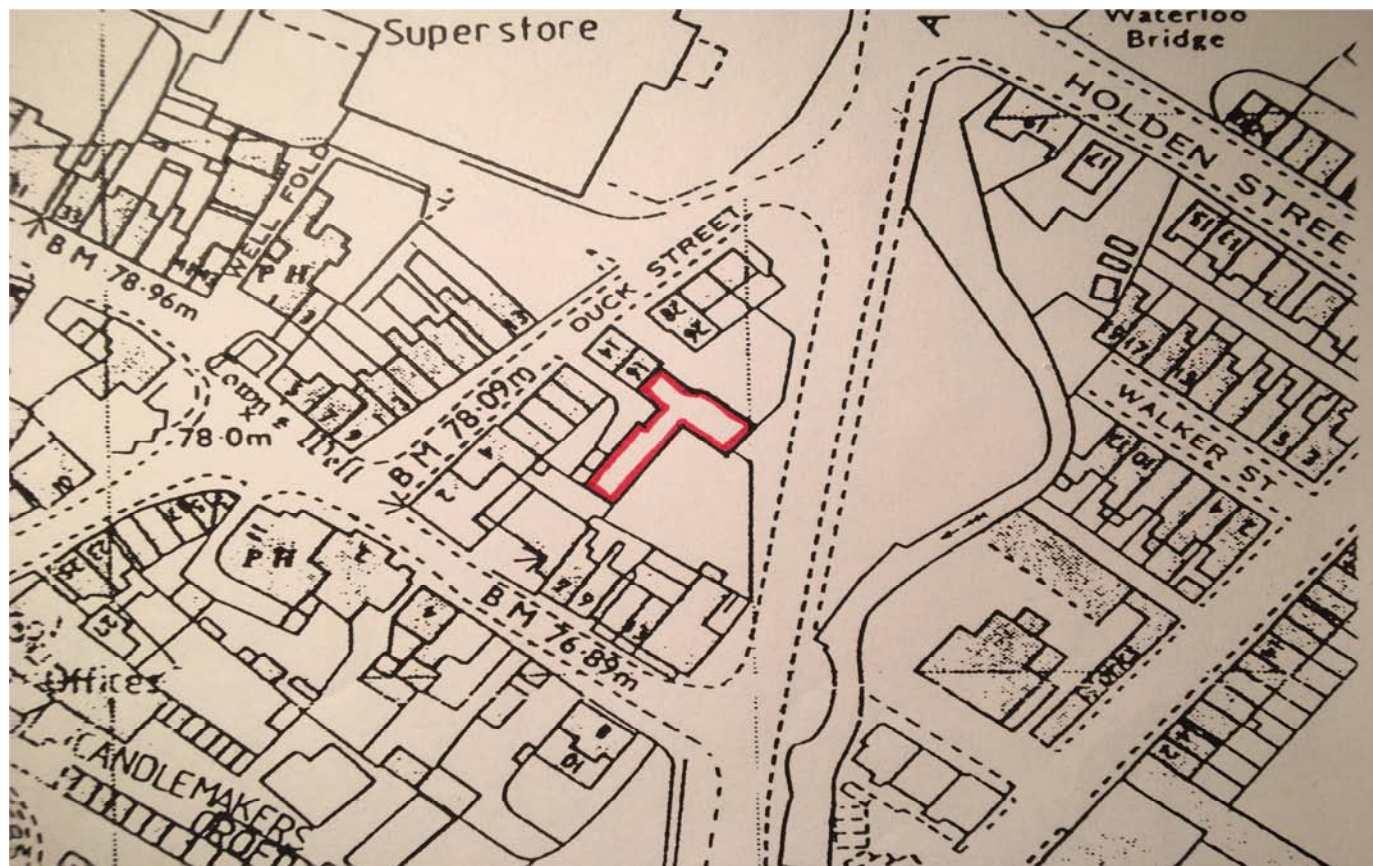

**From:** John Ridge [mailto:ri[REDACTED]om]  
**Sent:** 23 November 2017 20:15  
**To:** Andrew Hall  
**Subject:** The Stables

I've done it again! I realise that I have misread Houldsworth's 2000 red outline: it includes only the buildings. It excludes the "ginnel", as you call it, the entrance to and part of the yard to the S of Duck Street, up to but not including the building abutting both the Duck St stores and on the N side the Duck St cottages backyard wall. Please amend my earlier email accordingly.

I realise that this is not for you the crucial point!

Best wishes,

John

ridg[REDACTED]om