

Michael Robinson, email re: 8 Duck Street and “who owns what” land

- When I blow the docs up on my pc screen you get a very clear “straight lined” boundary with no sheds as you see as follows:

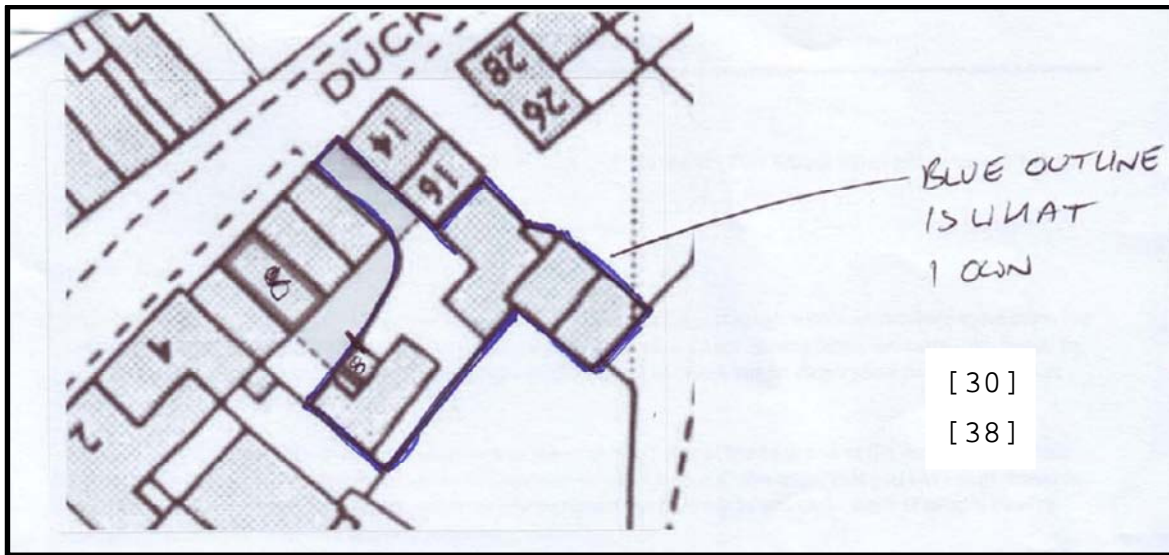

Here is a photograph of a wall which John Houldsworth advised M Robinson to build:



< Photograph of the unregistered yard at the rear of 8 Duck Street, taken from the registered yard of 10 Duck Street in 2017:

M Robinson re: No.8: *“I’d love to meet up if needed with your landlord and talk this through though my solicitor is very clear and told me to build it back up anyway”*

[18][35]